

FLOORPLAN VILLA RISSEN HAMBURG



VILLA RISSEN
HAMBURG







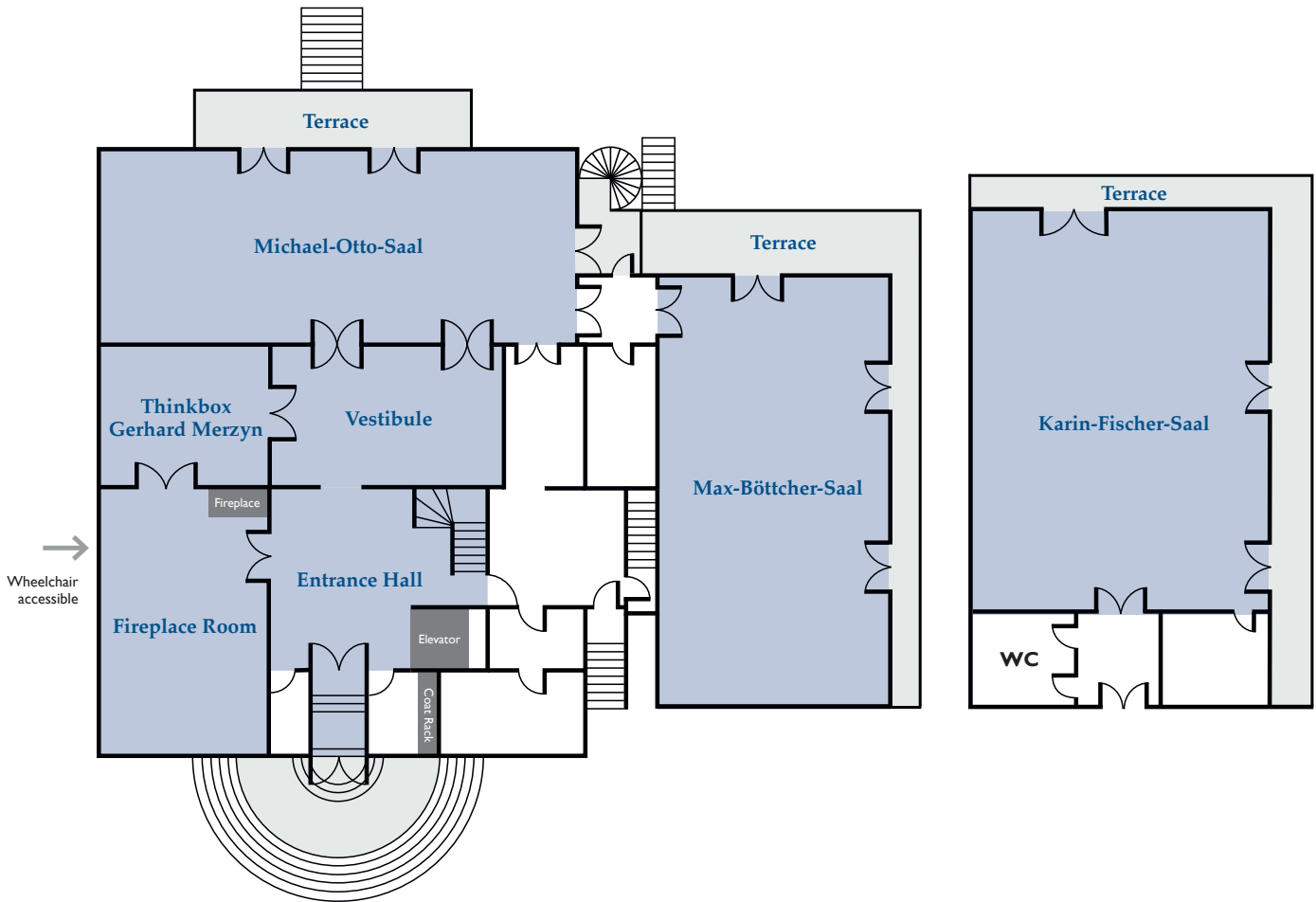

Floorplan

Ground Floor



Room Size **Height** **Seating**

									
			Class	Conference	U-Shape	Circle	Reception	Banquet	Theatre
Entrance Hall	33 sqm	2,80 m	-	-	-	-	20	-	-
Vestibule	33 sqm	2,80 m	-	-	-	-	20	16	-
Thinkbox GM	29 sqm	2,80 m	12	16	-	20	20	16	24
Fireplace Room	55 sqm	2,80 m	20	20	20	26	40	24	50
Max-Böttcher-Saal	99 sqm	2,80 m	40	32	24	40	150	64	120
Karin-Fischer-Saal	122 sqm	3,20 m	46	50	30	50	200	80-100	180
Michael-Otto-Saal	120 sqm	2,60 m	46	50	30	50	200	80-100	180



Floorplan



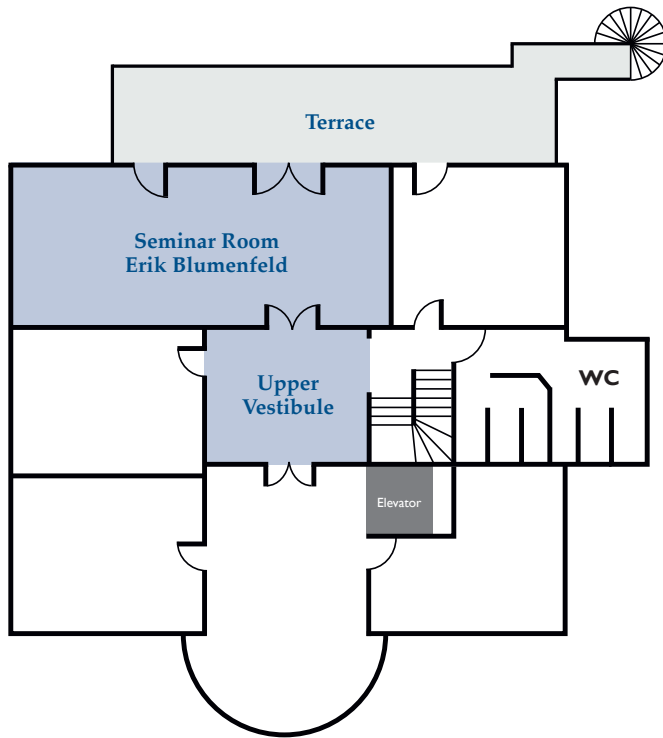

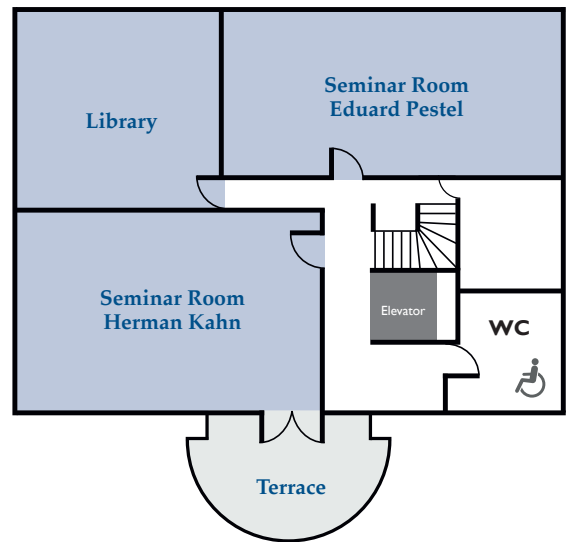

First Floor



Top Floor



Room Size Hight Seating

	Room Size	Hight	Seating					
								
			Class	Conference	U-Shape	Circle	Banquet	Theatre
Seminar Room Erik Blumenfeld	53 sqm	3,00 m	20	18	23	20	18	40
Seminar Room Eduard Pestel	40 sqm	3,50 m	16	24	16	22	-	-
Library	27 sqm	3,50 m	-	8	-	8	-	-
Seminar Room Herman Kahn	54 sqm	3,50 m	24	20	22	22	-	50



VILLA RISSEN
HAMBURG